

## RLP-2450

### 2.4 and 5 GHz Dual-Band/Dual-Port Antenna

The **RLP-2450** is a low profile 2 in 1 MIMO antenna that supports frequencies from 2.4 GHz to 7.2 GHz and includes a 6" (15cm) cable with Type SMA male connector. The Rajant RLP-2450 is designed for use with our Cardinal Node, ES1, and Sparrow BreadCrumbs®. It is IP69K so it can be deployed outdoors and is intended for warehouse automation, robotics, oil & gas, and utilities.



#### RLP-2450 Benefits

- Dual port 2.4 to 7.2 GHz antenna
- Omni-directional antenna with 4.9 dBi gain
- Easy installation, multiple mounting options
- IP 69K

#### Application Areas

- Smart utilities: Smart power, Gas & Water Metering
- Smart Buildings: Climate control, access control, security, irrigation
- Industrial factory automation, robotic machinery and other Industry 4.0 applications
- Digital Signage
- Warehouses & Logistic systems
- Transport (Busses, Utility & Public Safety)

#### Technical Data

Ports	2
SISO/MIMO	MIMO
Frequency Bands	2400 - 2500 MHz 5000 - 6000 MHz
Polarisation	Vertical
Peak Gain	4.3/4.9 dBi
Rated Wind	136 mph (220 km/h)
Connector Type	SMA - Type (M)
Cable Type/Length	RG-141 15cm/6in
Temperature	-40 to +80C

#### RF/Electrical Specifications

Rajant Part Number	Model	Frequency Range	Nominal Gain	Return Loss	Polarized	Connector Type
75-100161-003	RLP-2450-5-4-SM	2400-2500 MHz 5000-6000 MHz	4.3/4.9dBi	> 9 dB	Linear Vertical	SMA-m

#### Mechanical Specifications

Rajant Part Number	Model	Weight	Height	Diameter	Ingress	Impact
75-100161-003	RLP-2450-5-4-SM	13.3oz. (376g)	1.42in (3.6cm)	3.91in (9.9cm)	IP 69K	IK 10

## Radiation Patterns

Azimuth: 2400 – 2500 MHz

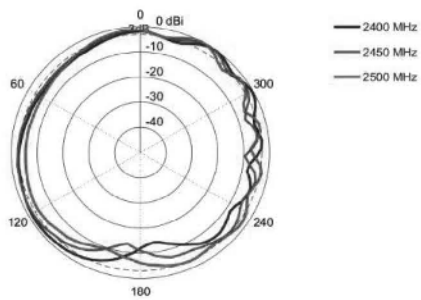

Azimuth: 5000 – 5400 MHz

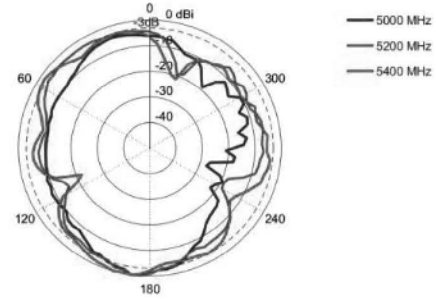

Azimuth: 5600 – 5800 MHz

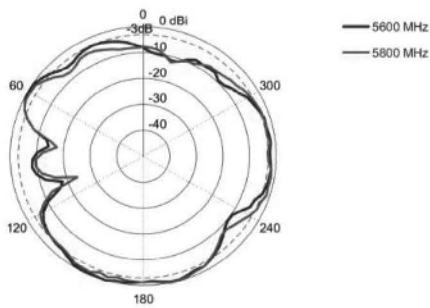

Azimuth: 6300 – 7200 MHz

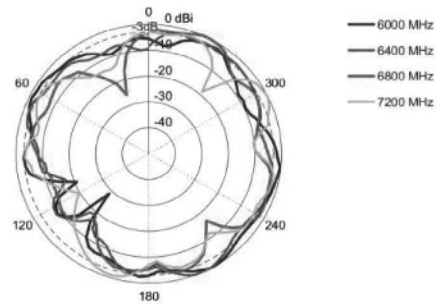

Elevation 1: 2400 – 2500 MHz

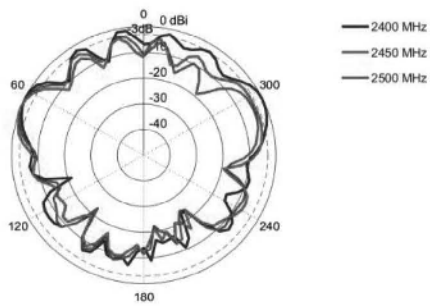

Elevation 1: 5000 – 5400 MHz

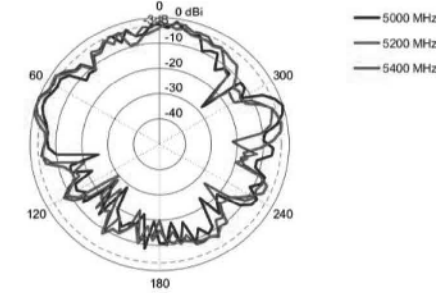

Elevation 1: 5600 – 5800 MHz

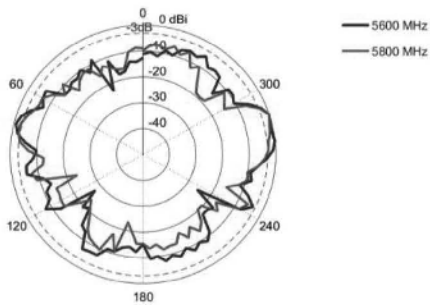

Elevation 1: 6000 – 7200 MHz

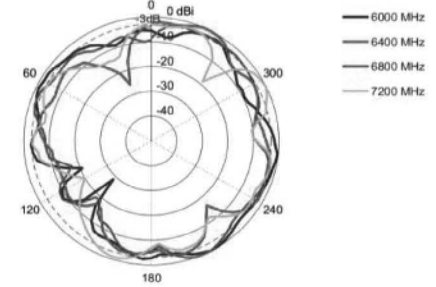

Elevation 2: 2400 – 2500 MHz

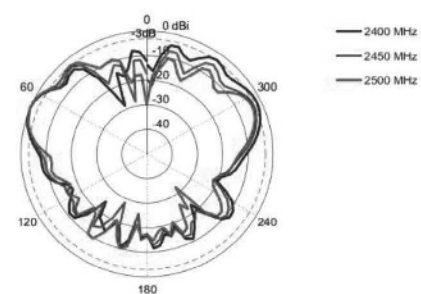

Elevation 2: 5000 – 5400 MHz

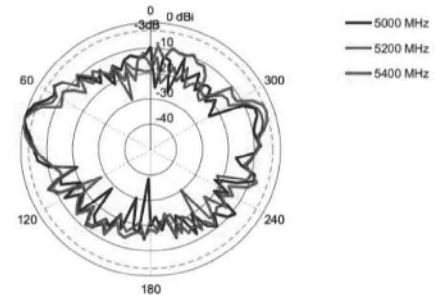

## Elevation 2: 5600 – 5800 MHz

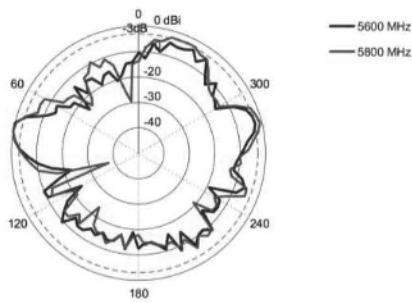

## Elevation 2: 6000 – 7200 MHz

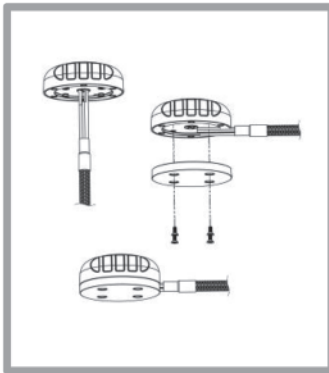
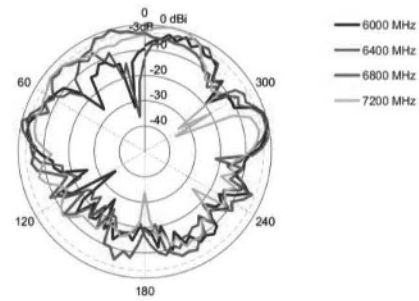
**Magnetic Mount**

Magnetic Base (included)  
For temporary and low mobility installations.

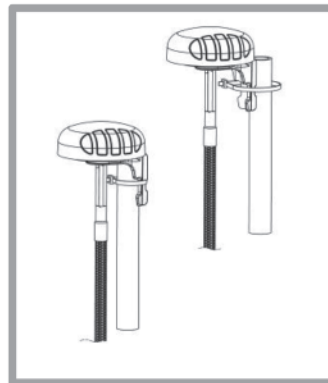
**Vertical Pole Mount**

Pole/Wall Mounting bracket

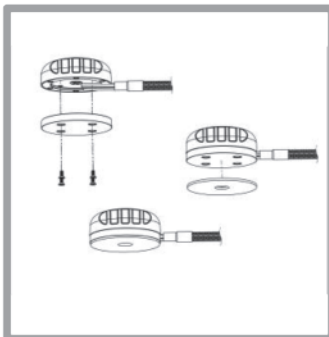
**Surface Mount**

Adhesive Surface Mounting (included) or can also be directly secured with longer M4 bolts (not included) to the female threaded inserts located in the antenna base

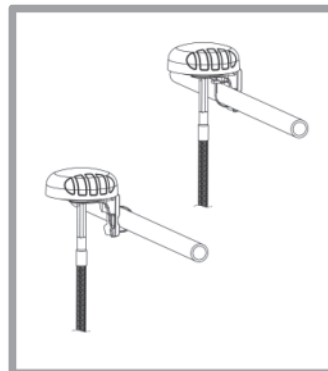
**Horizontal Pole Mount**

Pole/Wall Mounting bracket

**Wall Mount**

Pole/Wall Mounting bracket